



a.b.e.® Construction Chemicals METHODOLOGY Waterproofing Flat Boarded Roofs 3 ply malthoid and **abe**® unigum

SURFACE PREPARATION

Surface areas should be dry, clean and sound, free of voids, sharp protrusions or contaminants.

SUBSTRATES AND FALLS

Boards laid to minimum falls of 1 in 60, the strength and thickness as per engineers specification. The moisture content is not to exceed 7% prior to torch-on applications.

Should light weight screeds be employed an additional sand cement screed is to be placed on top of the light weight screed, the strength and thickness as per engineers specification. **Under no circumstances** must the torchon material be applied directly onto the light weight screeds.

Special care must be given to all expansion/construction joints, refer to you're **a.b.e.**® Technical Representative concerned for specific details.

PRIMING

1. New Roof

Prime all surfaces with **bitu.®prime**, including all verges, and around outlets and protrusions and allow the solvent to flash off. Extremely porous surfaces should be re-primed.

2. Rejuvenation

Strip existing waterproofing before priming all surfaces with **bitu.®prime**, including all verges, around outlets and protrusions and allow the solvent to flash off. Some existing waterproofing materials may be overlaid only in consultation with the **a.b.e.**® Technical Representative concerned.

SPECIFICATION

Index Fidia MS 4,5 kgs/m², South African Agreement Certified (Certificate No. 97/261)

Apply the first layer of **3 Ply malthoid** or **Index Rollbase** mechanically fastened to the boarded surface.

The **3 Ply malthoid** or **Index Rollbase** must be applied

providing for 100 mm side laps and end laps. The mechanical fasteners anchoring the **3 Ply malthoid** or **Index Rollbase** are to be spaced at intervals of 300 mm centres and shall be fixed incorporating 40 mm diameter washers.

A gusset section of **unigum 4 mm** is to be torched to the parapet to a minimum height of 100 mm up the parapet, brought down across at least 100 mm over the **3 Ply malthoid** or **Index Rollbase**.

Apply a second layer of **abe**® **unigum MS 4,5 kgs/m²**, ensuring that the second layer is fully bonded by means of 'torchon fusion' using propane gas, having side and end laps of 100 mm and 150 mm respectively.

The rolls are to run parallel to each other, centrally staggered to prevent joints overlapping.

See data sheet '**Six Golden Rules**'.

Additional gusset sections of 150 mm minimum up the parapet wall and dressed 150 mm minimum over the main waterproofing, **Index Fidia MS** 4,5 kgs.

FLASHING

Counter flashing over the balance of the parapet is recommended using **super laycryn** or **super laykold** incorporating **abe**® **membrane**, details as recommended in our data sheet. Ensure the lap over the torched membrane is at least 150 mm.

PROTECTION LAYERS

All plain exposed surfaces are to be treated with 2 coats of **silvakote** as protection layer against UV rays. The coating should be applied 6 to 8 weeks after torching process to allow the surface to oxidise slightly thus providing good adhesion of the coating.

DRAINAGE OUTLETS

Specific attention must be given to the detail work when waterproofing the outlets to prevent ingress of moisture.

GENERAL

Index waterproofing membranes shall only be installed by contractors accredited by **a.b.e.® Construction Chemicals Limited**.

Care must always be taken when working with open flames, potential fire hazard, and molten bitumen from the process, employ safety equipment and clothing where necessary.

All the products are to be applied in accordance with the manufacturers instructions.

All relevant data sheets are to be carefully read for additional information.

IMPORTANT NOTE

This data sheet is issued as a guide to the use of the product(s) concerned. Whilst **a.b.e.® Construction Chemicals Limited** endeavours to ensure that any advice,

recommendation, specification or information is accurate and correct, the company cannot - because **a.b.e.®** has no direct or continuous control over where and how **a.b.e.®** products are applied - accept any liability either directly or indirectly arising from the use of **a.b.e.®** products, whether or not in accordance with any advice, specification, recommendation, or information given by the company.

FURTHER INFORMATION

Where other products are to be used in conjunction with this material, the relevant technical data sheets should be consulted to determine total requirements. **a.b.e.® Construction Chemicals Limited** has a wealth of technical and practical experience built up over years in the company's pursuit of excellence in building and construction technology.

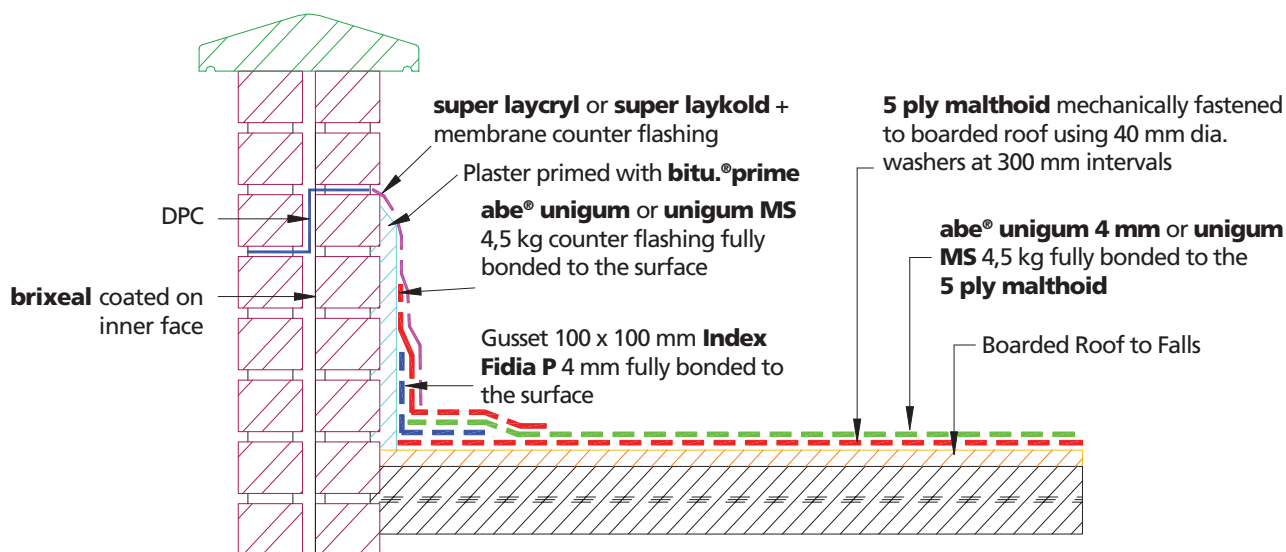

Note: All exposed plain surfaces are to be treated with 2 coats of **abe silvakote** for protection against UV rays



a.b.e.® is an ISO 9001:2008 registered company
PO Box 5100, Boksburg North, 1461, South Africa
Website: www.abe.co.za | Tel: +27(0) 11 306 9000
Durban | Johannesburg | Cape Town | Port Elizabeth | East London | Bloemfontein | George

a.b.e.® is a Chryso Group Company

CHRYSO
CHEMICAL SOLUTIONS FOR THE
CONSTRUCTION MATERIALS INDUSTRY